



Adattatori per strumentazione  
Instruments adapters

NIPPO CORPO ESAGONALE LUNGO MASCHIO  
MALE HEX LONG NIPPLE

**Materiale:** 316/316L

**Material:** 316/316L

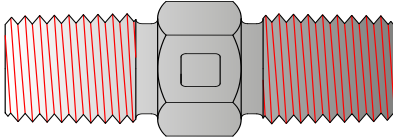

CODICE CODE	NPT MALE THREAD		W HEX	D	R
	T1	T2	mm	mm	mm
12.13.04.01.00010001	1/8	1/8	12	27	9.7
12.13.04.01.00010002	1/4	1/8	17	31.8	14.2/9.7
12.13.04.01.00010003	1/4	1/4	17	37	14.2
12.13.04.01.00010004	3/8	1/8	19	32.3	14.2/9.7
12.13.04.01.00010005	3/8	1/4	19	37	14.2
12.13.04.01.00010006	3/8	3/8	19	37	14.2
12.13.04.01.00010007	1/2	1/4	22	43.2	19.1/14.2
12.13.04.01.00010008	1/2	3/8	22	43.2	19.1/14.2
12.13.04.01.00010009	1/2	1/2	22	48	19.1
12.13.04.01.00010010	3/4	1/4	27	45.2	19.1/9.7
12.13.04.01.00010011	3/4	1/2	27	50	19.1
12.13.04.01.00010012	3/4	3/4	27	50	19.1
12.13.04.01.00010013	1	1	36	59.4	23.9

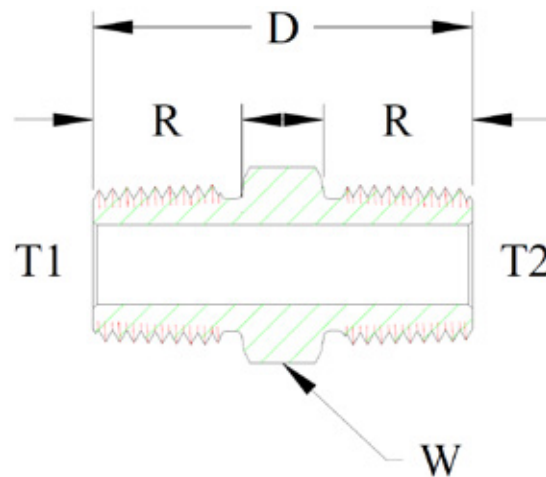



Adattatori per strumentazione  
*Instruments adapters*

NIPLO CORPO ESAGONALE MASCHIO  
 MALE HEX NIPPLE

**Materiale:** 316/316L

**Material:** 316/316L

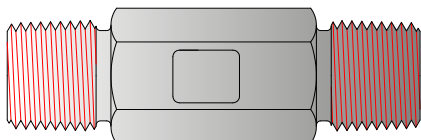

CODICE CODE	NPT MALE THREAD	W HEX mm	D mm	R mm
12.13.04.01.00010014	1/8	12	35	9.7
12.13.04.01.00010015	1/8	12	50	9.7
12.13.04.01.00010016	1/8	12	65	9.7
12.13.04.01.00010017	1/8	12	75	9.7
12.13.04.01.00010018	1/4	17	50	14.2
12.13.04.01.00010019	1/4	17	65	14.2
12.13.04.01.00010020	1/4	17	75	14.2
12.13.04.01.00010021	1/4	17	100	14.2
12.13.04.01.00010022	1/2	22	50	19.1
12.13.04.01.00010023	1/2	22	75	19.1
12.13.04.01.00010024	1/2	22	100	19.1

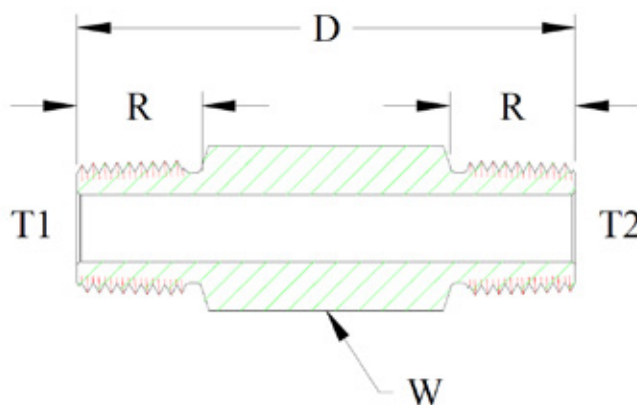



Adattatori per strumentazione  
Instruments adapters

ADATTATORE MASCHIO/FEMMINA  
MALE/FEMALE ADAPTER

**Materiale:** 316/316L

**Material:** 316/316L

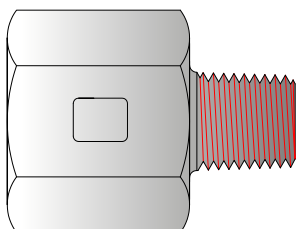

CODICE CODE	NPT THREAD		W HEX mm	D mm	R mm
	Male	Female			
12.13.04.01.00010025	1/8	1/4	19	31	9.7
12.13.04.01.00010026	1/4	1/4	19	35.6	9.7
12.13.04.01.00010027	1/8	3/8	22	36.6	9.7
12.13.04.01.00010028	1/4	3/8	22	36.6	14.2
12.13.04.01.00010029	3/8	3/8	22	36.6	9.7
12.13.04.01.00010030	1/8	1/2	30	38.1	9.7
12.13.04.01.00010031	1/4	1/2	30	43	14.2
12.13.04.01.00010032	3/8	1/2	30	43	14.2
12.13.04.01.00010033	1/2	1/2	30	47.8	19.1
12.13.04.01.00010034	1/4	3/4	36	45.2	14.2
12.13.04.01.00010035	1/2	3/4	36	49.3	19.1
12.13.04.01.00010036	1/4	1	41	51	9.7
12.13.04.01.00010037	1/2	1	41	54.9	19.1
12.13.04.01.00010038	3/4	1	41	55.7	19.1

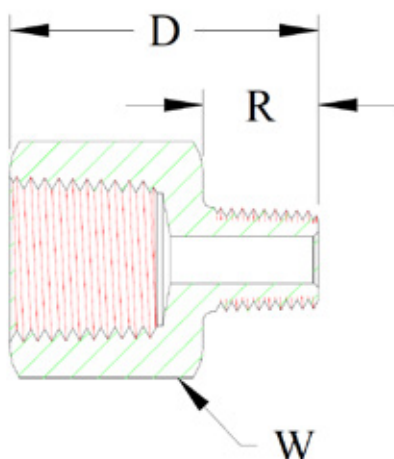



Adattatori per strumentazione  
*Instruments adapters*

MANICOTTO CORPO ESAGONALE  
 FEMALE HEX COUPLING

**Materiale:** 316/316L

**Material:** 316/316L

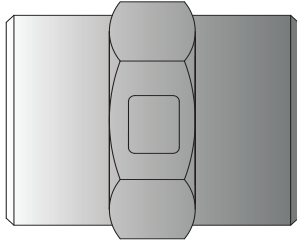

CODICE CODE	NPT FEMALE THREAD	W HEX	D
		Inch	mm
12.13.04.01.00010039	1/8	1/8	17
12.13.04.01.00010040	1/4	1/8	19
12.13.04.01.00010041	1/4	1/4	19
12.13.04.01.00010042	3/8	1/8	22
12.13.04.01.00010043	3/8	1/4	22
12.13.04.01.00010044	3/8	3/8	22
12.13.04.01.00010045	1/2	1/4	30
12.13.04.01.00010046	1/2	3/8	30
12.13.04.01.00010047	1/2	1/2	30
12.13.04.01.00010048	3/4	1/4	36
12.13.04.01.00010049	3/4	1/2	36
12.13.04.01.00010050	3/4	3/4	36
12.13.04.01.00010051	1	1	41

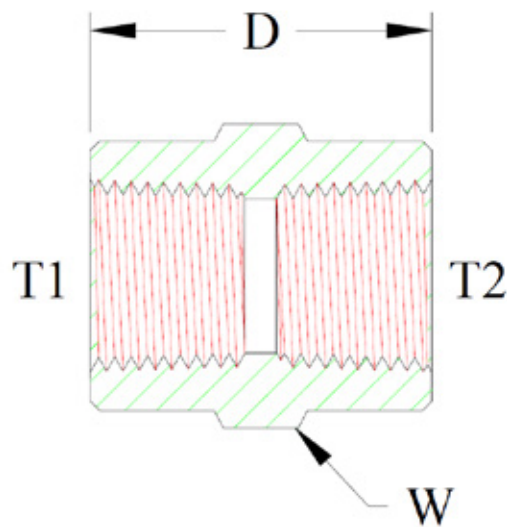



Adattatori per strumentazione  
*Instruments adapters*

RIDUZIONE MASCHIO/FEMMINA  
 MALE/FEMALE REDUCING

**Materiale:** 316/316L

**Material:** 316/316L

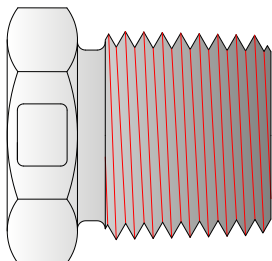

CODICE CODE	NPT THREAD		W HEX	D
	Male	Female	mm	mm
12.13.04.01.00010052	1/4	1/8	17	21.3
12.13.04.01.00010053	3/8	1/8	19	21.3
12.13.04.01.00010054	3/8	1/4	19	21.3
12.13.04.01.00010055	1/2	1/8	22	27.7
12.13.04.01.00010056	1/2	1/4	22	27.7
12.13.04.01.00010057	1/2	3/8	22	27.7
12.13.04.01.00010058	3/4	1/4	27	29.7
12.13.04.01.00010059	3/4	3/8	27	29.7
12.13.04.01.00010060	3/4	1/2	27	29.7
12.13.04.01.00010061	1	3/8	36	35.5
12.13.04.01.00010062	1	1/2	36	35.5
12.13.04.01.00010063	1	3/4	36	35.5

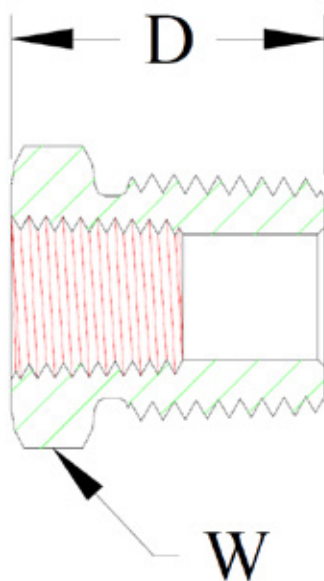



Adattatori per strumentazione  
*Instruments adapters*

GOMITO MASCHIO  
*MALE ELBOW*

**Materiale:** 316/316L

**Material:** 316/316L

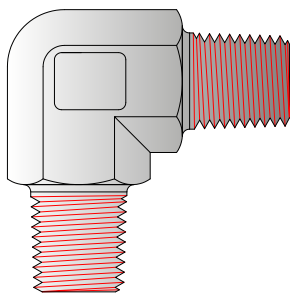

CODICE CODE	NPT MALE THREAD	W HEX mm	H1 mm	R mm
12.13.04.01.00010064	1/8	12	20	9.7
12.13.04.01.00010065	1/4	14	28	14.2
12.13.04.01.00010066	3/8	19	31	14.2
12.13.04.01.00010067	1/2	22	37.3	19.1
12.13.04.01.00010068	3/4	27	40.4	19.1

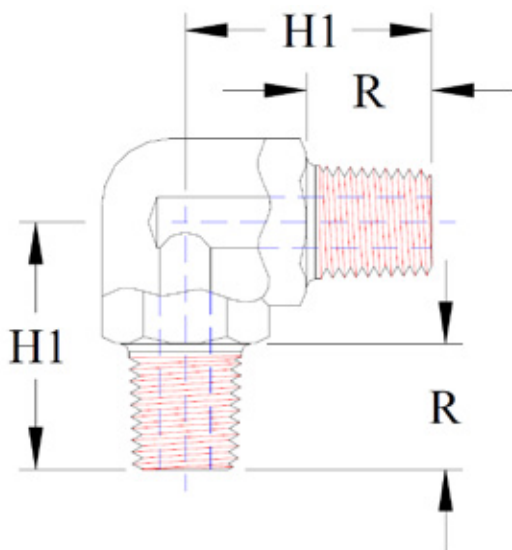



Adattatori per strumentazione  
Instruments adapters

GOMITO MASCHIO/FEMMINA  
MALE/FEMALE ELBOW

**Materiale:** 316/316L

**Material:** 316/316L

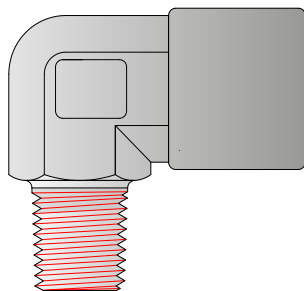

CODICE CODE	NPT MALE/FEMALE THREAD		W HEX	H	H1
	Male	Female	mm	mm	mm
12.13.04.01.00010069	1/8	1/8	14	16.8	19.8
12.13.04.01.00010070	1/4	1/8	14	22.4	23.1
12.13.04.01.00010071	1/4	1/4	19	22.4	27.7
12.13.04.01.00010072	3/8	3/8	22	26	31
12.13.04.01.00010073	1/2	1/2	27	31.2	37.3
12.13.04.01.00010074	3/4	3/4	32	34.5	40.4
12.13.04.01.00010075	1	1	41	41.4	50

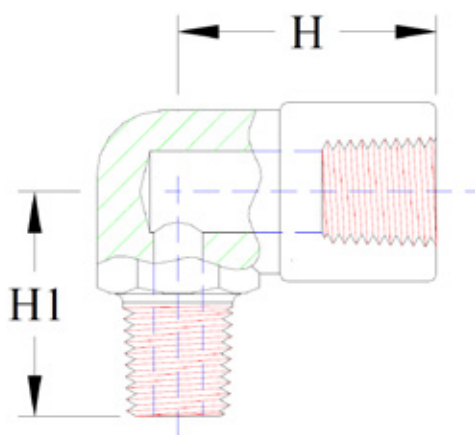



Adattatori per strumentazione  
Instruments adapters

GOMITO FEMMINA  
FEMALE ELBOW

**Materiale:** 316/316L

**Material:** 316/316L

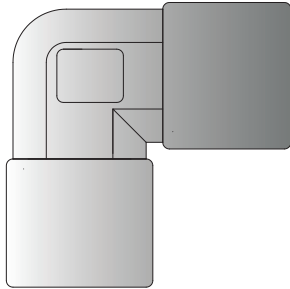

CODICE CODE	NPT FEMALE THREAD		W HEX	H
			mm	mm
12.13.04.01.00010076	1/8	1/8	17	19.1
12.13.04.01.00010077	1/4	1/8	19	24
12.13.04.01.00010078	1/4	1/4	19	28.7
12.13.04.01.00010079	3/8	1/8	22	26.2
12.13.04.01.00010080	3/8	1/4	22	28.7
12.13.04.01.00010081	3/8	3/8	22	28.7

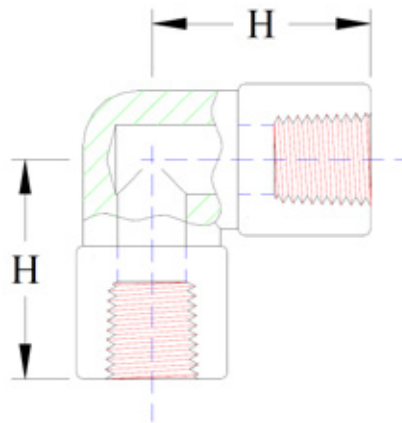





Adattatori per strumentazione  
Instruments adapters

INCROCIO FEMMINA  
FEMALE CROSS

**Materiale:** 316/316L

**Material:** 316/316L

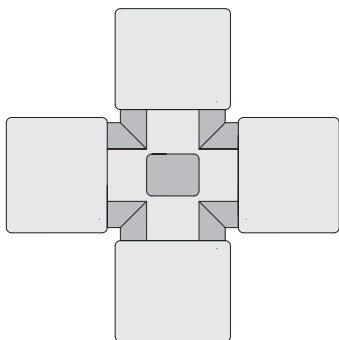

CODICE CODE	NPT FEMALE THREAD	W HEX mm	H mm
12.13.04.01.00010082	1/8	14	16.8
12.13.04.01.00010083	1/4	19	22.4
12.13.04.01.00010084	3/8	22	26
12.13.04.01.00010085	1/2	27	31.2

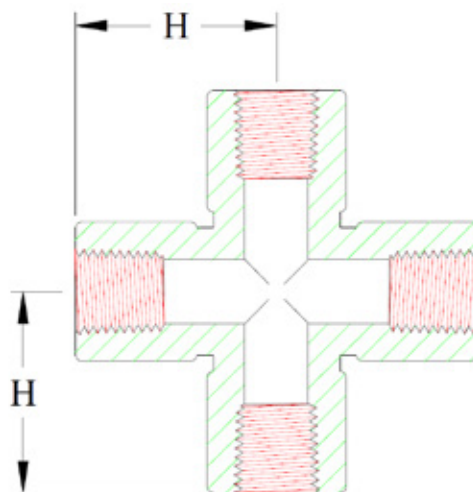



Adattatori per strumentazione  
*Instruments adapters*

UNIONE A T MASCHIO  
 MALE TEE

**Materiale:** 316/316L

**Material:** 316/316L

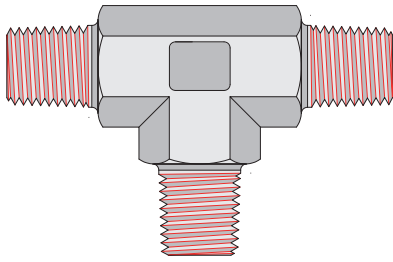

CODICE CODE	NPT MALE THREAD	W HEX mm	H mm
12.13.04.01.00010086	1/8	14	19.8
12.13.04.01.00010087	1/4	19	27.7
12.13.04.01.00010088	3/8	22	31
12.13.04.01.00010089	1/2	27	37.3

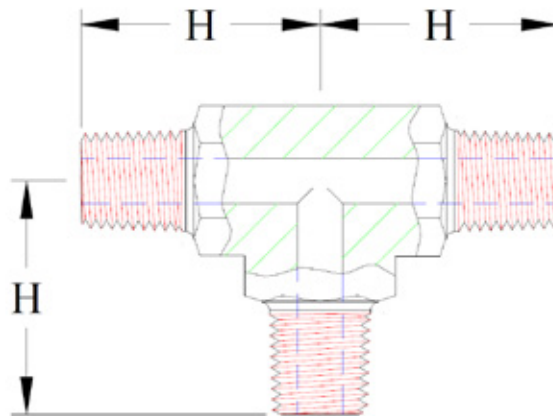



Adattatori per strumentazione  
Instruments adapters

UNIONE A T MASCHIO/FEMMINA  
MALE/FEMALE TEE

**Materiale:** 316/316L

**Material:** 316/316L

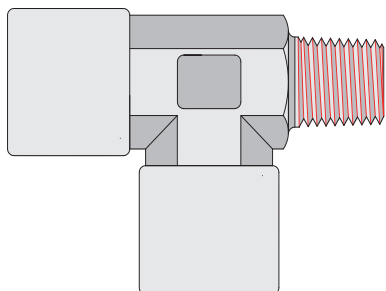

CODICE CODE	NPT MALE/FEMALE THREAD	W HEX	H	H1	R
		mm	mm	mm	mm
12.13.04.01.00010090	1/8	14	16.8	19.1	9.7
12.13.04.01.00010091	1/4	19	22.4	27.7	9.7
12.13.04.01.00010092	3/8	22	26	31	14.2
12.13.04.01.00010093	1/2	17	31.2	37.3	19.1

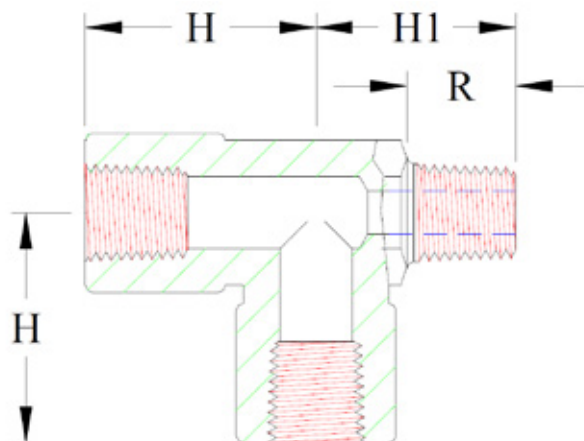



Adattatori per strumentazione  
Instruments adapters

UNIONE A T FEMMINA  
FEMALE TEE

**Materiale:** 316/316L

**Material:** 316/316L

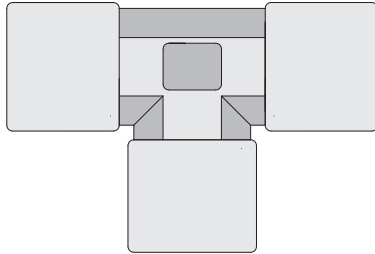

CODICE CODE	NPT FEMALE THREAD	W HEX mm	H mm
12.13.04.01.00010094	1/8	14	16.8
12.13.04.01.00010095	1/4	19	22.4
12.13.04.01.00010096	3/8	22	26
12.13.04.01.00010097	1/2	27	31.2
12.13.04.01.00010098	3/4	32	34.5
12.13.04.01.00010099	1	41	41.4

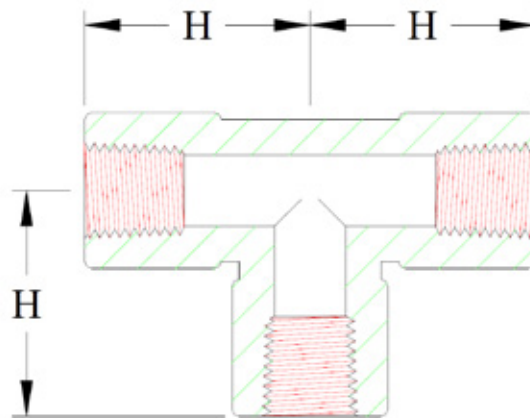



Adattatori per strumentazione  
Instruments adapters

UNIONE A T CON DERIVAZIONE MASCHIO  
MALE BRANCH TEE

**Materiale:** 316/316L

**Material:** 316/316L

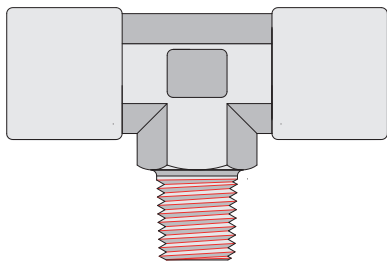

CODICE CODE	NPT THREAD	W HEX	H	H1	R
		mm	mm	mm	mm
12.13.04.01.00010100	1/8	14	16.8	19.1	9.7
12.13.04.01.00010101	1/4	19	22.4	27.7	9.7
12.13.04.01.00010102	3/8	22	26	31	14.2
12.13.04.01.00010103	1/2	27	31.2	37.3	19.1

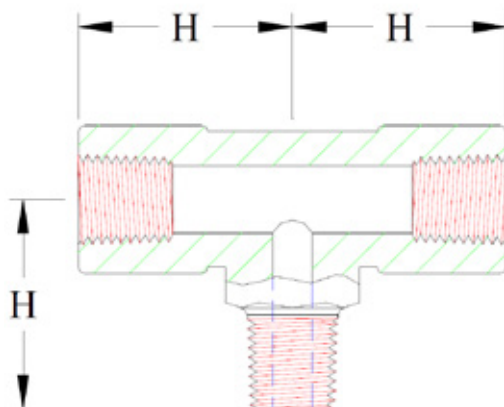



Adattatori per strumentazione  
*Instruments adapters*

TAPPO FEMMINA  
*FEMALE PLUG*

**Materiale:** 316/316L

**Material:** 316/316L

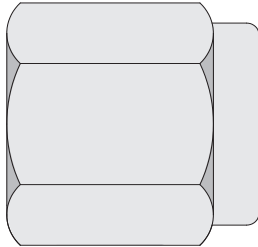

CODICE CODE	NPT FEMALE THREAD	W HEX mm	D mm
12.13.04.01.00010104	1/8	14	19.8
12.13.04.01.00010105	1/4	19	27.7
12.13.04.01.00010106	3/8	22	31
12.13.04.01.00010107	1/2	27	37.3

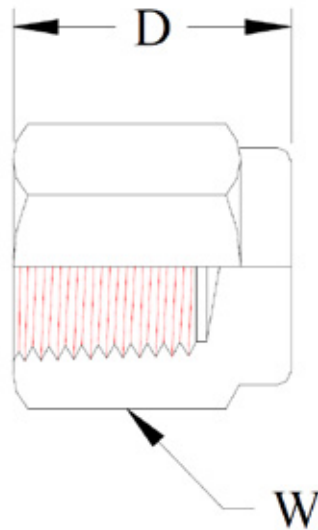



Adattatori per strumentazione  
*Instruments adapters*

TAPPO MASCHIO  
*MALE PLUG*

**Materiale:** 316/316L

**Material:** 316/316L

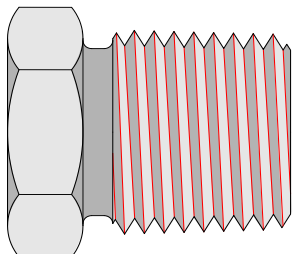

CODICE CODE	NPT MALE THREAD	W HEX	D
		mm	mm
12.13.04.01.00010108	1/8	12	14.2
12.13.04.01.00010109	1/4	14	19.1
12.13.04.01.00010110	3/8	17	19.8
12.13.04.01.00010111	1/2	22	24.6
12.13.04.01.00010112	3/4	26	29.2
12.13.04.01.00010113	1	36	34

