

ANCHOR HEAD NUTS					
CODE			DIMENSIONS	Box/Pcs	WEIGHT (Kg/100)
GROUP	MATERIAL	TYPE	D (mm)		
AC	ZC	DA0 0M6000 0000 00	M6	100	3
AC	ZC	DA0 0M8000 0000 00	M8	100	3
AC	ZC	DA0 M10000 0000 00	M10	100	3.4
AC	ZC	DA0 M12000 0000 00	M12	100	4.5

MATERIALS	
ZC	HDG

On request available in AISI 316

*The set can be supplied complete with washer and hexagon or cylinder head screw

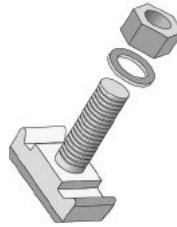

ANCHOR HEAD SCREW					
CODE			DIMENSIONS	Box/Pcs	WEIGHT (Kg/100)
GROUP	MATERIAL	TYPE	D (mm)		
AC	ZC	TA0 M10030 0000 00	M10	100	3.2
AC	ZC	TA0 M12040 0000 00	M12	100	3.9

MATERIALS	
ZC	HDG

On request available in AISI 316

The set can be supplied complete with washer and hexagon nut

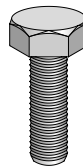

ANCHOR HEAD NUTS						
CODE			SCREW LENGHT (mm)	THREAD	Box/Pcs	WEIGHT (Kg/100)
GROUP	MATERIAL	TYPE				
AC	ZE	TEX 0M6020 0000 00	20	M6	100	0.58
AC	ZE	TEX 0M6030 0000 00	30	M6	100	0.75
AC	ZE	TEX 0M6040 0000 00	40	M6	100	0.94
AC	ZE	TEX 0M6050 0000 00	50	M6	100	1.12
AC	ZE	TEX 0M6060 0000 00	60	M6	100	1.24
AC	ZE	TEX 0M6070 0000 00	70	M6	100	1.46
AC	ZE	TEX 0M8020 0000 00	20	M8	100	1.22
AC	ZE	TEX 0M8030 0000 00	30	M8	100	1.55
AC	ZE	TEX 0M8040 0000 00	40	M8	100	1.88
AC	ZE	TEX 0M8050 0000 00	50	M8	100	2.21
AC	ZE	TEX 0M8060 0000 00	60	M8	100	2.55
AC	ZE	TEX 0M8070 0000 00	70	M8	100	2.86
AC	ZE	TEX M10020 0000 00	20	M10	100	2.26
AC	ZE	TEX M10030 0000 00	30	M10	100	2.76
AC	ZE	TEX M10040 0000 00	40	M10	100	3.26
AC	ZE	TEX M10050 0000 00	50	M10	100	3.76
AC	ZE	TEX M10060 0000 00	60	M10	100	4.26
AC	ZE	TEX M10070 0000 00	70	M10	100	4.76
AC	ZE	TEX M12020 0000 00	20	M12	100	3.23
AC	ZE	TEX M10030 0000 00	30	M12	100	3.96
AC	ZE	TEX M12040 0000 00	40	M12	100	4.7
AC	ZE	TEX M12050 0000 00	50	M12	100	5.44
AC	ZE	TEX M12060 0000 00	60	M12	100	6.18
AC	ZE	TEX M12080 0000 00	80	M12	100	7.65

MATERIALS	
ZC	HDG

Available in AISI 316 or 304 on request